

Workshop manual
LC 247, LC 247S, LC 247SP,
LC 347V, LC 347VI,
LC 353V, LC 353VI



English

Workshop Manual

300 series

(LC 353VI, LC 353V, LC 347VI, LC 347V)

200 series

(LC 253S, LC 247, LC 247S, LC 247SP)

Contents

1 Introduction and safety regulations	3	
1.1 General	3	
1.2 Revisions.....	3	
1.3 Target group	3	
1.4 Safety instructions.....	3	
1.4.1 General safety instructions	3	
1.4.2 Special safety instructions	3	
1.5 Symbols on the product	4	
2 Delivery and service.....	5	
2.1 Service schedule.....	5	
2.2 Assembly and control.....	6	
2.2.1 To assemble the handle.....	6	
2.2.2 To adjust the handle height.....	6	
2.2.3 To assemble the grass catcher.....	6	
2.2.4 To assemble the mulching-kit	7	
2.3 To do a test run	7	
2.3.1 To start the engine (LC 247, LC 247S, LC 247SP, LC 347V, LC 253S, LC 353V).....	7	
2.3.2 To start the engine (LC 347VI, LC 353VI).....	7	
2.3.3 To stop the engine	7	
2.3.4 To do a test of the drive (LC 247S, LC 247SP).....	8	
2.3.5 Speed control.....	8	
2.4 Final inspection	8	
3 Design and function.....	9	
3.1 Serial number.....	9	
3.1.1 Type plate/Product serial number	9	
3.2 Engine	9	
3.3 Drive.....	9	
3.4 Cutting equipment.....	9	
4 Repair instructions.....	10	
4.1 To replace the blade.....	10	
4.2 To replace the engine.....	10	
4.3 To remove the front axle.....	11	
4.4 To remove the rear axle (with drive).....	11	
4.5 To remove the rear axle (without drive).....	13	
4.6 To replace the drive belt	13	
4.7 To test the engine brake.....	14	
4.7.1 Electric start (LC 347VI, LC 353VI).....	14	
4.8 To replace the wires	14	
4.8.1 To change the the engine break wire	14	
4.8.2 To change the Throttle wire.....	14	
4.8.3 To change the Speed control wire	15	
4.9 Battery (electrical start)	15	
4.9.1 Charge the battery.	15	
4.10 To examine the spark plug	16	
4.11 To adjust the drive belt	16	
4.11.1 Variable Speed (LC 347V, LC 347VI, LC 353V,LC 353VI)	16	
4.12 Air filter	16	
4.12.1 To clean the paper filter	17	
4.12.2 To clean the foam plastic filter (LC 247, LC 247S, LC 247SP)	17	
4.12.3 To change the oil.....	17	
4.12.4 To examine the fuel system	17	
5 Specifications	18	
5.1 Technical data 300 series.....	18	
5.2 Technical data 200 series.....	19	

1 Introduction and safety regulations

1.1 General

This workshop manual gives a full description of how to do troubleshooting, repairs and tests of the lawn mower. It also gives safety instructions that the personnel must obey during repair work.

1.2 Revisions

If there are changes to the product, these are gradually introduced into ongoing production. These changes can have an effect on servicing and/or spare parts. This can cause sections of the workshop manual to become out of date. Servicing information is sent out for each change. To make sure that the repair and servicing instructions are complete and up to date, always read the workshop manual together with all servicing information applicable for the lawn mower.

1.3 Target group

This workshop manual is written for personnel with a general knowledge of how to repair and do servicing on lawn mowers.

All personnel that repair or do servicing on the lawn mower must read and understand the workshop manual.

1.4 Safety instructions



WARNING: All personnel that repair or do servicing on the lawn mower must read and understand the safety instructions.

Warning symbols can be found in this workshop manual and on the lawn mower. Refer to "1.5 Symbols on the product". Replace the warning symbol decal as soon as possible if a warning symbol on the product is damaged or missing.

1.4.1 General safety instructions

The service center that repairs the lawn mower must have safety devices that comply with local regulations.

Warnings and cautions are used to point out specially important parts of the workshop manual.



WARNING: Used if there is a risk of injury or death if the instructions are not followed.



CAUTION: Used if there is a risk of material damage if the instructions are not followed.

1.4.2 Special safety instructions

When you use compressed air, do not point the air jet in the direction of your body. Air can go into the blood circulation and kill you.

Use eye protection when you do work on springs that have tension.

Only use an appropriate Briggs & Stratton battery with this product. Follow the safety instructions for the battery and charger.



Do not use accessories and/or do changes that are not approved by the manufacturer. This can cause injury or death to the operator or other persons.



WARNING: Always use original spare parts and accessories.



WARNING: Use approved hearing protection. Noise from the product can result in permanent hearing loss.

1.5 Symbols on the product



Careless or incorrect use of this product can result in serious or fatal injury to the operator or others.



Read the operator's manual and make sure that you understand the instructions before you use this product.



Keep persons and animals at a safe distance from the work area.



Remove the ignition cable from the spark plug to prevent accidental start.



Dipstick/oil filter



Fast



Slow



Choke



Look out for thrown objects and ricochets.



Warning: rotating blade. Keep hands and feet clear.



Warning: rotating parts. Keep hands and feet clear.



Do not run the product indoors or in closed spaces. The exhaust fumes from the engine contain carbon monoxide, an odourless, poisonous and very dangerous gas.



Hot surface.



Risk of explosion.



The engine is delivered without oil.



Fill with oil before using the product.



Do not use fuel that is sold as E85 (85% ethanol)



Remove the safety switch (battery) before you do maintenance or let the product stay unattended.



The product agrees with applicable EC directives.



Noise emission to the environment according to the European Community's Directive. The product's emission is specified in the Technical data chapter and on the label.



Risk of fire.



Release brake arm before starting the engine.



Stop

2 Delivery and service

2.1 Service schedule

Descriptions of the maintenance below are found in the operator's manual.

See the engine manual for servicing information for the engine.

Daily Maintenance	Before use	After each use	Every 10 hours	Every 25 hours	Every 100 hours	Before storage
Lawn mower						
Tighten bolts and nuts.	X					X
Clean / Inspect Grass Catcher *	X	X				X
Check tires	X					
Check drivewheels***	X					
Clean the machine****		X				X
Clean under the drive cover***			X			
Check the drive belt / Pulleys***				X		
Check that the cutter is undamaged and not cracked. Replace the cutter if necessary.				X ³		
General lubrication				X		
Clean and Recharge Battery **				X		X ⁴
Engine						
Check the engine's oil level	X ⁵					
Change engine oil				X ^{1,2}		
Clean the air filter. Replace if necessary.				X ²		
Check that the muffler is securely attached and not damaged.				X		
Replace the spark plug.					X	
Empty fuel tank or add Stabilizer						X

* If so equipped

** Machines equipped with electric start

***Power-Propelled machines

****Use a scraper to clean under deck

Note 1: When operating with a heavy load or at high ambient temperatures, or other extreme conditions, service the machine more often. Note 2: Clean more often if conditions are exceptionally dusty. Note 3: Replace blades more often when mowing in sandy soil. Note 4: Charge the battery for max. 48 hours. Note 5: And after 5 hours of use.

2.2 Assembly and control

2.2.1 To assemble the handle

1. Loosen the lower knobs.
2. Slide the knobs to the ends of the grooves on both sides of the machine.

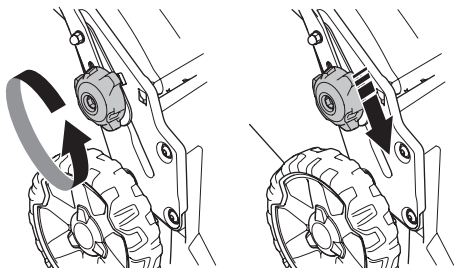

3. Fold the handles to its upright position.

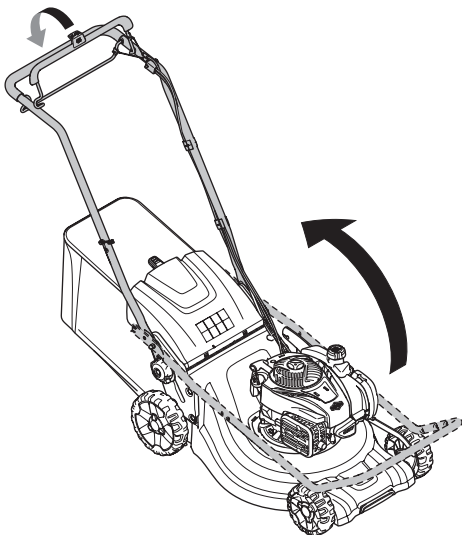

4. Slide the knobs up towards the handle until they stop and a click is heard.

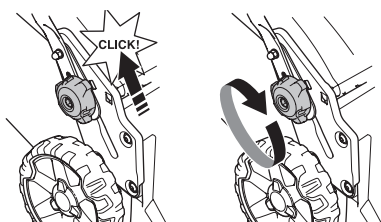

5. Screw on the handle with the knob.
6. Connect the starter cord.

2.2.2 To adjust the handle height

1. Loosen the lower knobs.

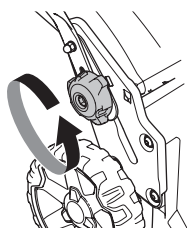

2. Move the knobs up in the direction of the handle until they stop and a click is heard. Handle height can be set to 2 different positions, Tighten the knobs fully.

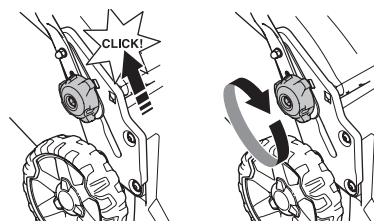

2.2.3 To assemble the grass catcher

1. The collector's handle situated on the frame must be placed over the collector bag.

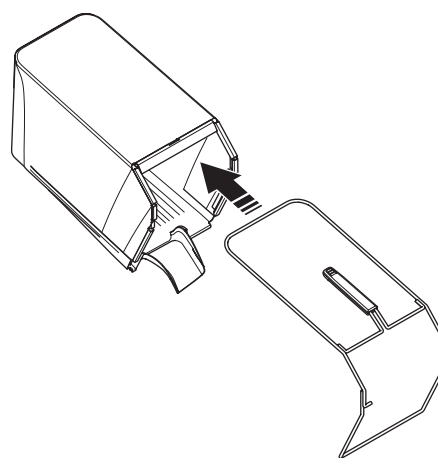

2. Fasten the lower part of the frame in the groove underneath the collector.
3. Secure the frame by using the quick-action clips.

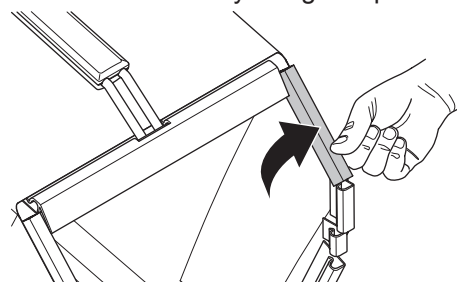

4. Make sure the machine's discharge deck is clean and free from grass cuttings.
5. Hook the collector onto the top edge of the chassis.
6. Place the collector tongue in the machine's discharge deck.

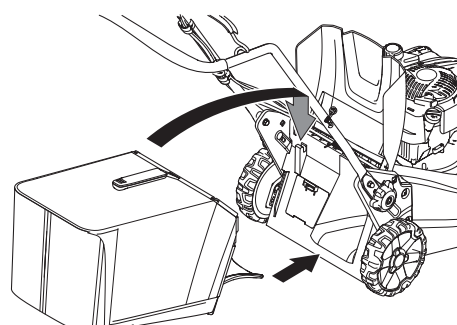

7. Fit the bagger bottom on the discharge deck.

2.2.4 To assemble the mulching-kit

1. Raise the discharge guard to mount / dismount the mulch plug.

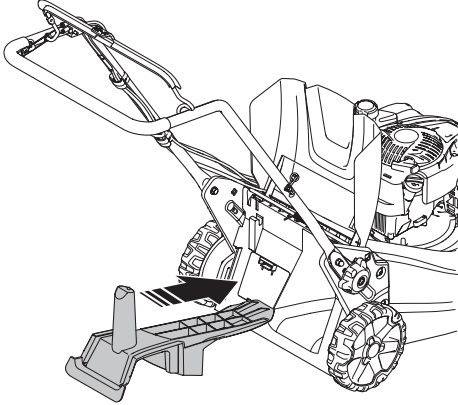

2. Replace the blade with the supplied Combi blade. For more information, see "Cutting equipment".

2.3 To do a test run



CAUTION: A too low oil level can do damage to the engine. Do a check of the oil level before you start the product.

2.3.1 To start the engine (LC247, LC 247S, LC 247SP, LC 347V, LC 253S, LC 353V)

The models LC 247 and LC 247S have manual choke. The first time the product is started, press the fuel pump 5 times. When the engine is started cold after that, press the fuel pump 3 times.

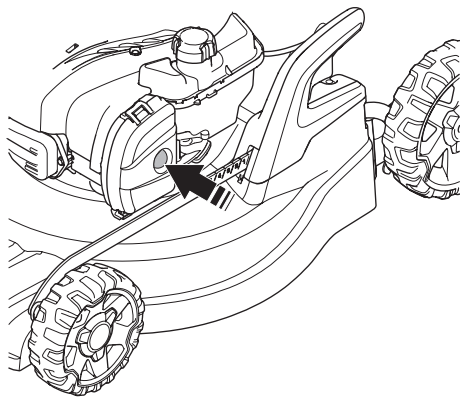

1. Make sure that the ignition cable is connected to the spark plug.
2. Push the engine brake handle down.

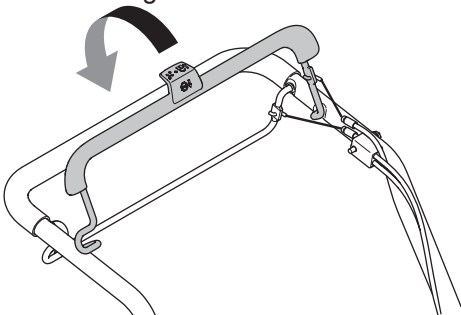

3. Hold the starter handle and slowly pull out the cord until you feel resistance.
4. Pull with force to start the engine.
5. Make sure that the blade starts to rotate.

2.3.2 To start the engine (LC 347VI, LC 353VI)

The models LC 348VI and LC 353VI have electric start.

1. Make sure that the ignition cable is connected to the spark plug.
2. Make sure that the battery is activated and charged. See chapter 4.9 Battery.
3. Attach the battery to the engine.

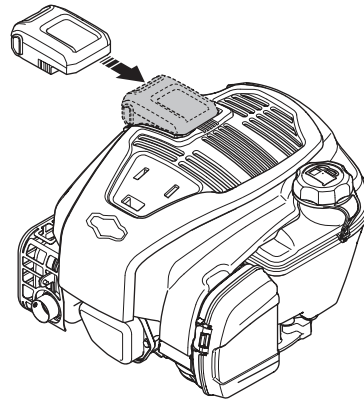

4. Push the start inhibitor to the side.

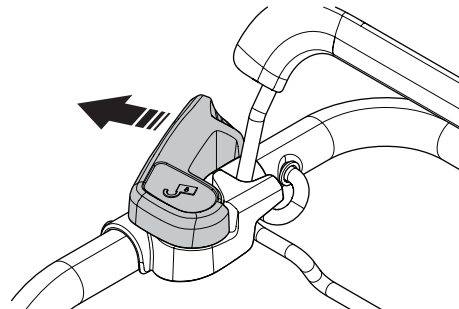

5. Pull the engine break handle against the handlebar to start the starter motor. The starter motor stops when the engine starts.

2.3.3 To stop the engine

Release the engine brake handle and make sure that the engine stops.

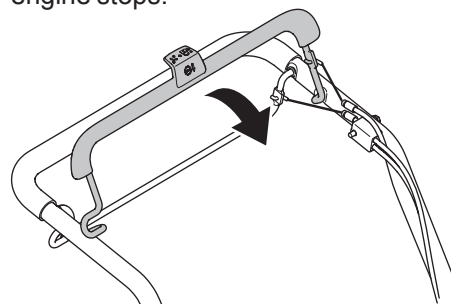

2.3.4 To do a test of the drive (LC 247S, LC 247SP)

1. Start the engine.
2. Pull the propulsion bar in the direction of the handle to start the drive.

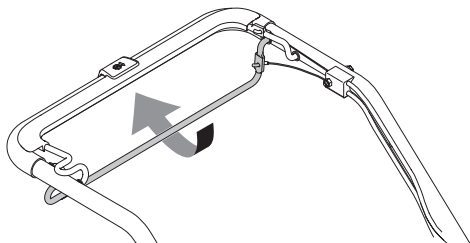

On machines with variable speed, this is adjusted with the control on the left-hand side.

2.3.5 Speed control

Examine the maximum engine speed with a Husqvarna original tachometer. Adjust the maximum speed according to the table.

Model	RPM
LC 253S, LC 353V, LC 353VI	2800 ± 100 rpm
LC 347VI, LC 347V, LC 247, LC 247S, LC 247SP	2900 ± 100 rpm

2.4 Final inspection

Before releasing the product to the customer make sure that:

- The blade is correctly attached and that the blade turns correctly.
- The blade stops spinning when the blade stop is engaged.
- The safety inhibitor is undamaged and works correctly.
- The engine brake arm is undamaged and works correctly.
- All nuts and bolts are attached with the correct torque.
- The chassis is undamaged.
- The handle is undamaged.
- The wheels are attached correctly and undamaged.

3 Design and function

3.1 Serial number

3.1.1 Type plate/Product serial number

The product serial number is given on the type plate. Stated on the plate, from the top, is the information that follows:

- Model name
- Article number
- Weight
- Product serial number

Please provide model name and product serial number when you order spare parts.

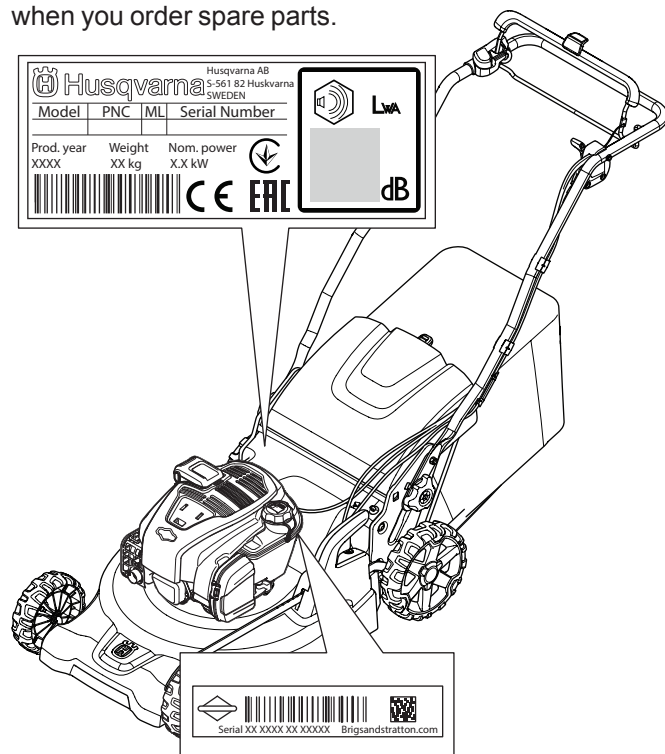

LC 347V	Self propelled Variable speed
LC 347VI	Self propelled Variable speed INSTART
LC 353V	Self propelled Variable speed
LC 353VI	Self propelled Variable speed INSTART

3.4 Cutting equipment

All products in the 200 and 300 series can be used with a combi blade together with a grass catcher, or with an optional mulching-kit.

3.2 Engine

The product has a engine manufactured by Briggs & Stratton.

Use only original spare parts to repair the engine. If other spare parts are used, the warranty is void.

Major engine repairs are not described in the workshop manual. Manuals with detailed information about engine adjustments and repairs are available at approved servicing dealers or downloaded from the website of the engine manufacturer. Provide the engine serial number when you send an order for the manual.

3.3 Drive

Model	Drive system
LC 247	Push
LC 247S	Self propelled
LC 247SP	Self propelled

4 Repair instructions



WARNING: Before you start any repairs, stop the engine and remove the ignition cable from the spark plug. Remove the battery on products with electrical start.

4.1 To replace the blade



WARNING: The blade is sharp and can cause cuts. Wear protective gloves.

1. Lock the blade with a wooden block. Remove the blade screw and the washer.

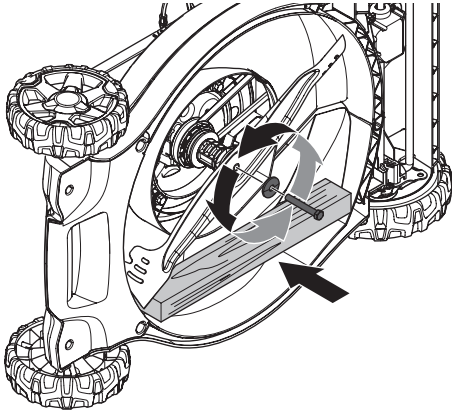

2. Remove the blade. Make sure that the blade bracket and the blade screw are free of damage, and that the motor shaft is not bent.
3. Attach the new blade with the angled ends in the direction of the cover.

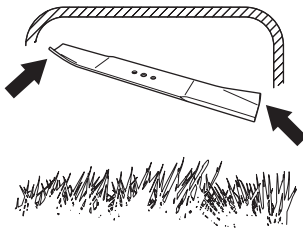

4. Make sure that the blade aligns with the center of the shaft.

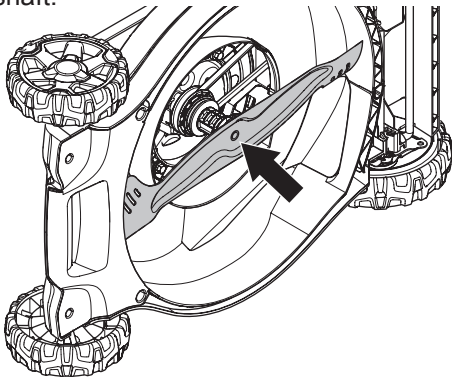

5. Attach the washers and the blade screw and tighten with a torque of 70 Nm.

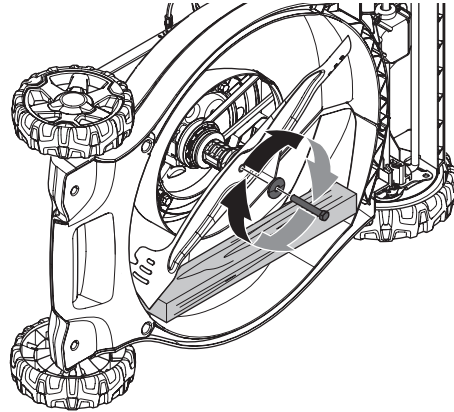

6. Pull the blade around by hand and make sure that it rotates freely.
7. Test run the product.

4.2 To replace the engine

1. Detach the engine brake cable.

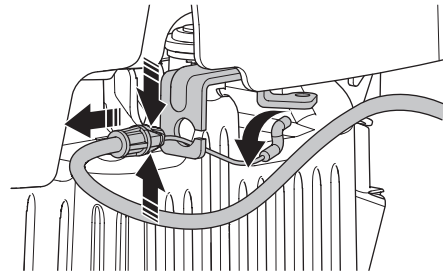

2. Remove the screw, washer and blade.

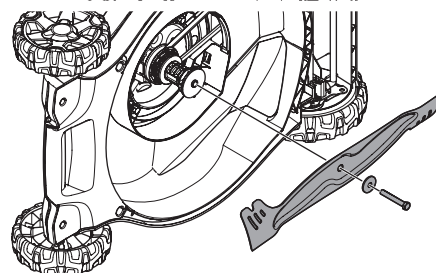

3. Remove the blade support and the pulley assembly.

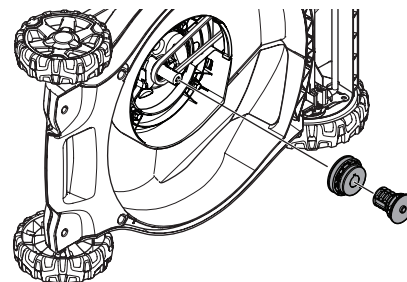

4. Unscrew the three screws and lift out the engine.

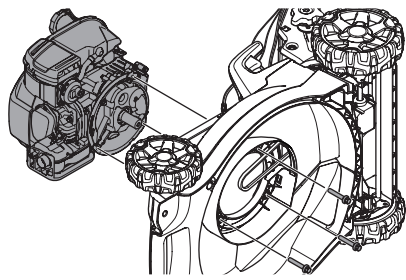

5. Unclip the sleeves if necessary.

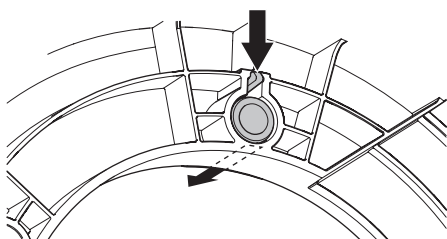

4.3 To remove the front axle

1. Remove the skid plate and disconnect the height adjuster.

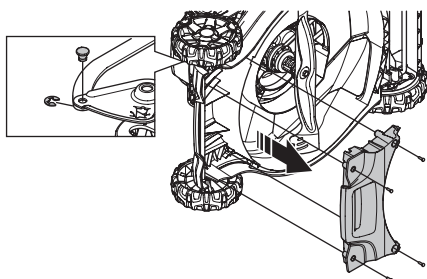

2. Remove the wheel and axis assembly

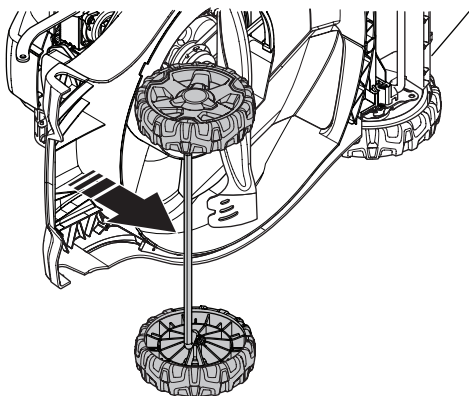

3. Remove the wheel caps. Remove the screw. Remove and replace the bearings.

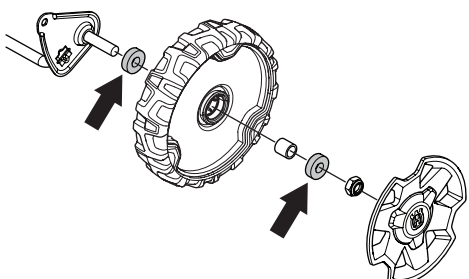

4.4 To remove the rear axle (with drive)

The following procedures applies for both sides:

1. Remove the wheel caps.

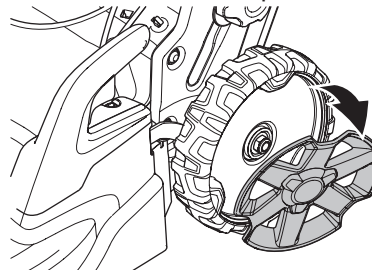

2. Remove the wheel.

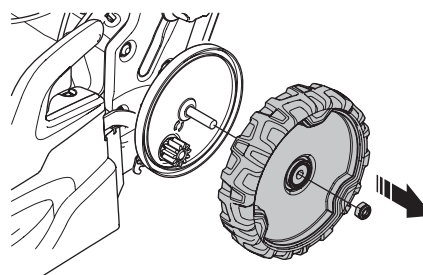

3. Remove the circlip using a circlip plier and remove the pinion, washer and inner circlip.

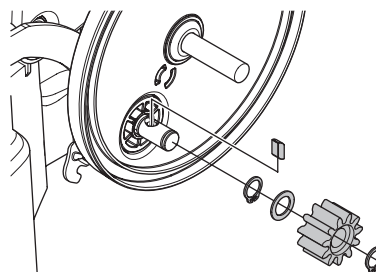

4. Remove the dust cover.

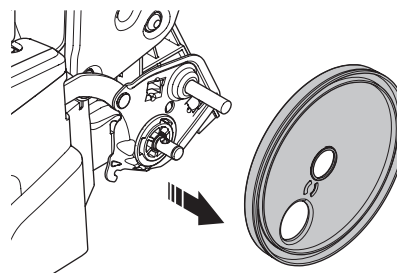

5. Adjust the cutting deck to its highest position by pressing the button as shown in the illustration.

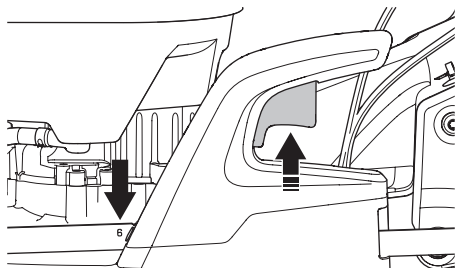

6. Turn the mower on its side. Use a wooden blocks to stabilize the mower. Lock the blade with a wooden block

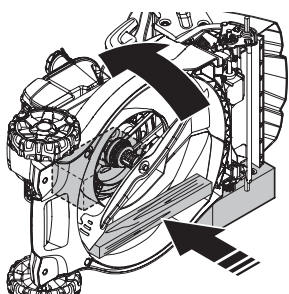

7. Remove the blade.

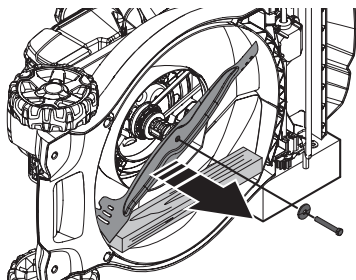

8. Use a hook to lift of the spring with a firm and explosive movement.

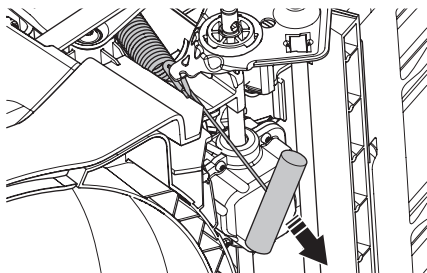

9. Remove the shaft and circlip to detach the height mechanism from the link arm

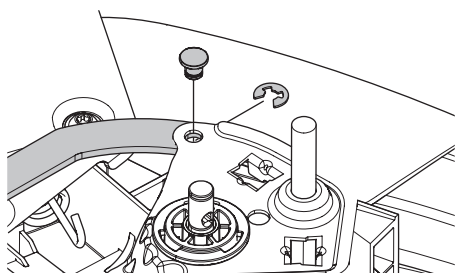

10. Pull off the link arm and tube as one unit then remove the wheel axle.

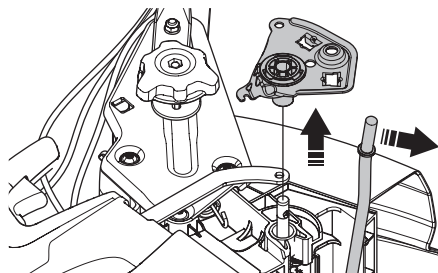

11. Pull out the bushing using a pair of pliers.

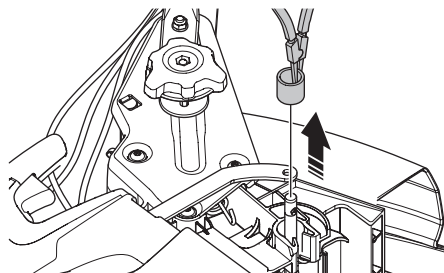

12. Remove the belt cover for ease of access.

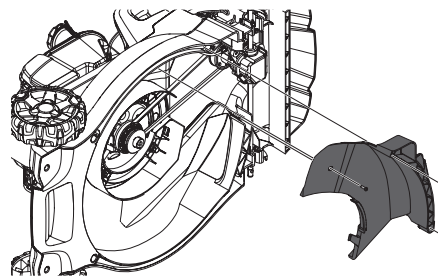

13. Remove the belt.

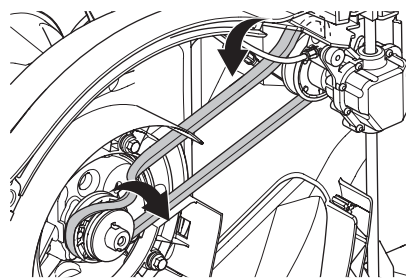

14. Remove the inspection cover for ease of access.

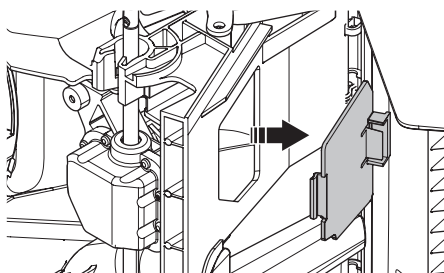

15. Reach through the inspection hole and unhook the throttle wire

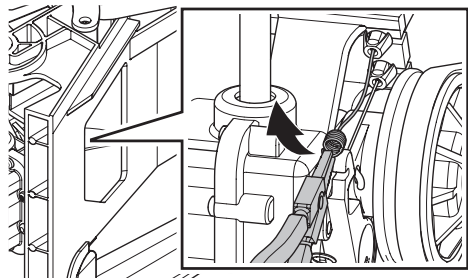

16. Compress the plastic clips and remove the wire.

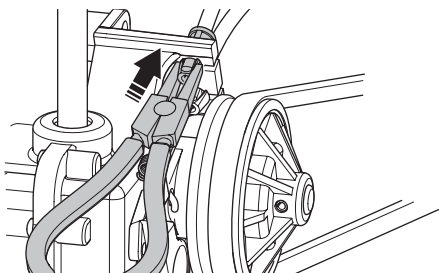

17. If the product is equipped with a speed control unit, reach through the inspection hole and unhook the speed control wire from the gearbox.

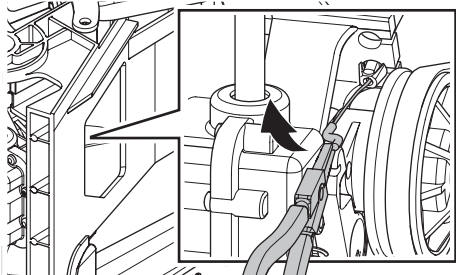

18. Compress the plastic clips and remove the wire.

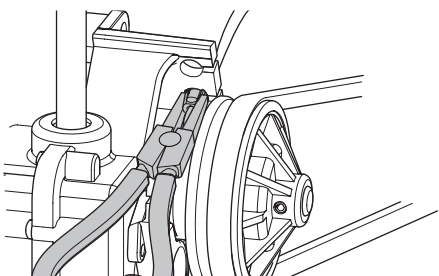

19. Use a circlip plier to separate the plastic stops.

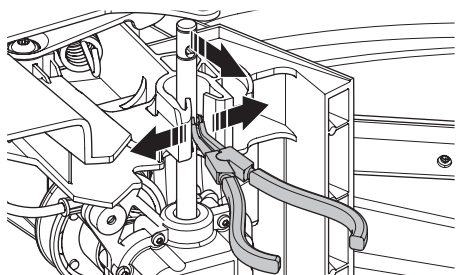

20. Pull out the rear axle with the gearbox.

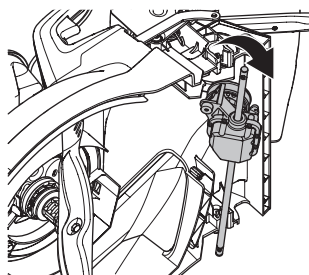

4.5 To remove the rear axle (without drive)

Use bent pliers to pry apart the plastic stops and pull out the rear axle.

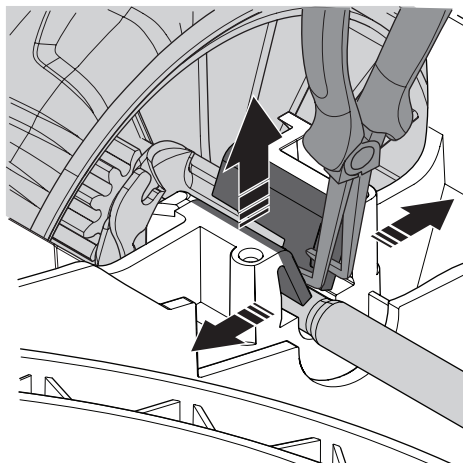

4.6 To replace the drive belt

1. Lock the blade with a wooden block. Remove the blade screw and the washer.

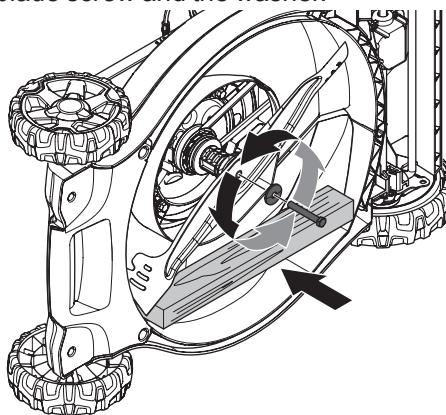

2. Remove the blade support.

3. Remove the belt cover for ease of access.

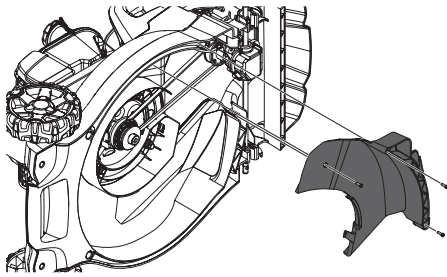

4. Remove the belt.

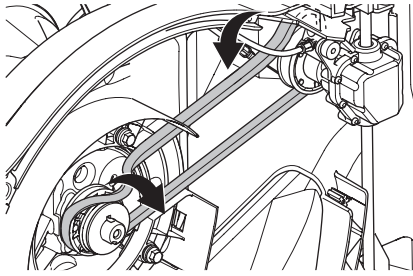

4.7 To test the engine brake

Test the engine break:

- If the engine has been changed
- If the engine break cable has been changed.

Make sure the lever arm of the engine break goes all the way back when the engine break handle is pushed down.

Make sure that the blade stops within 3 seconds after releasing the engine brake.

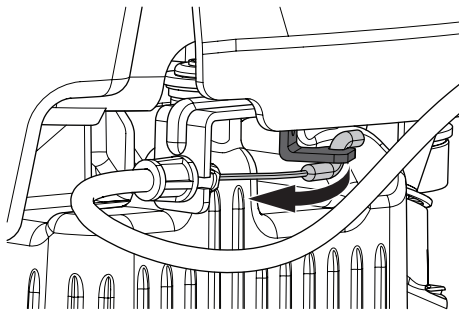

4.7.1 Electric start (LC 347VI, LC 353VI)

If the product is equipped with an electrical start switch, examine the bail arm and make sure that the engine can't start unless the start inhibitor is pulled to the side.

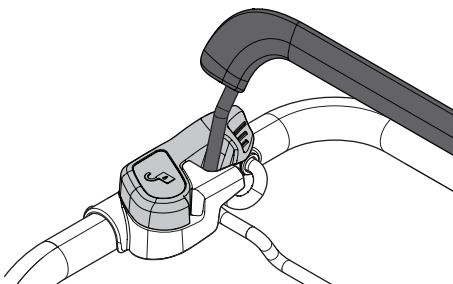

4.8 To replace the wires

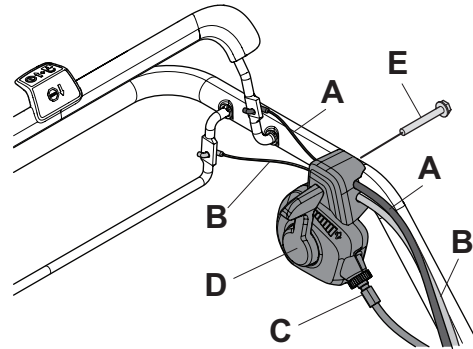

A Engine break wire

B Throttle wire

C Speed control wire (only in LC 353VI, LC 353V, LC347VI and LC 347V))

E Screw

4.8.1 To change the the engine break wire

1. Remove the screw (E) and remove the speed control unit (D).
2. Remove the engine break wire from the engine.

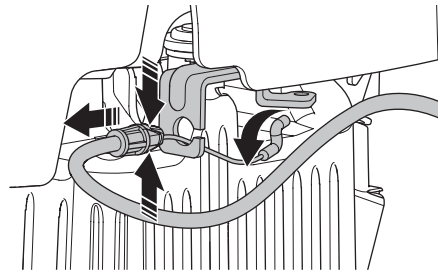

4.8.2 To change the Throttle wire

1. Remove the screw (E) and remove the speed control unit (D).
2. Remove the inspection cover for ease of access.

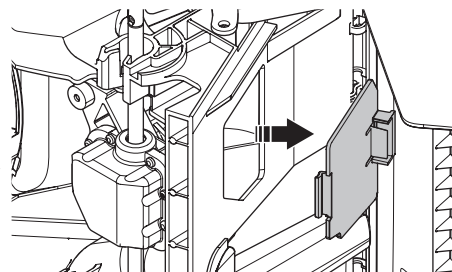

3. Reach through the inspection hole and unhook the throttle wire from the gearbox.

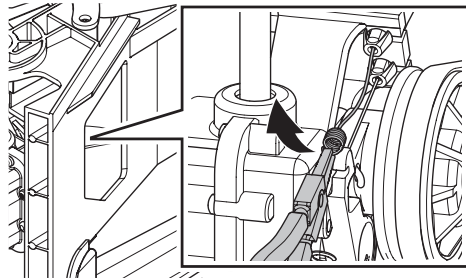

4. Compress the plastic clips and remove the throttle wire.

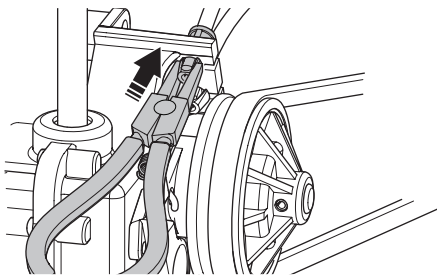

4. Reach through the inspection hole and unhook the speed control wire from the gearbox.

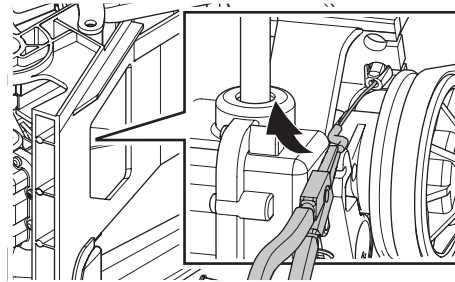

5. Compress the plastic clips and remove the wire.

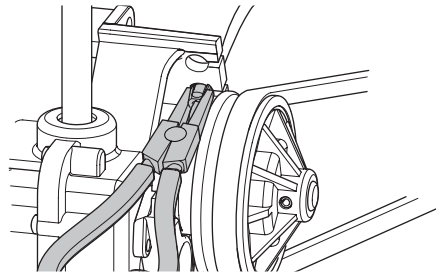

4.8.3 To change the Speed control wire

1. Detach the lower part of the speed cable with the upper part.

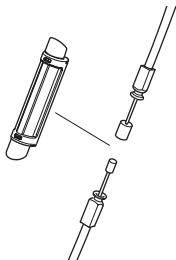

2. Remove the screw (E) and remove the speed control unit (D).
3. If the lower part of the speed wire needs to be replaced. Remove the inspection cover for ease of access.

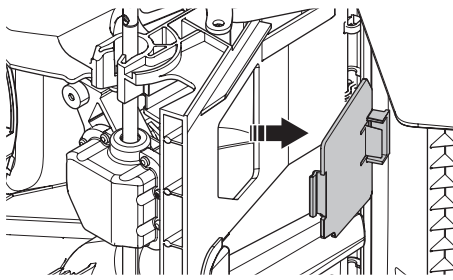

4.9 Battery (electrical start)

IMPORTANT!

An exhausted battery must not be disposed of as household garbage! Leave it at your nearest service agent or collection point.

The battery is a safety switch and must only be mounted on the engine when the machine is in use.

The battery is an intelligent 10.8V lithium battery that must be activated before being used for the first time.

Place the battery into the charger and wait until at least 1 green lamp comes on (10 seconds). The battery can then be mounted on the engine.

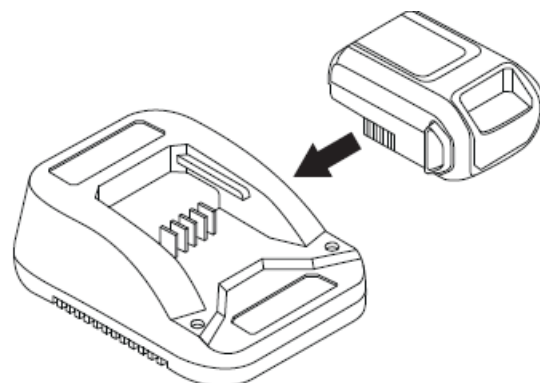

4.9.1 Charge the battery.

The battery has an easy-check voltage indicator with LEDs (1-4).

If the voltage is too low (1 or 0 LEDs lit), place the battery in the charger and connect to a wall socket (220V, 50Hz).

A flat battery will be fully charged after about 60 minutes.

The battery can be quick-charged for shorter periods without damage

LED display on the battery	Status
LED 1 flashes	0% - 25%
LED 1 is lit LED 2 flashes	25% - 50%
LED 1 is lit LED 2 is lit LED 3 flashes	50% - 75%
LED 1 is lit LED 2 is lit LED 3 is lit LED 4 flashes	75% - 100%
LED 1 is lit LED 2 is lit LED 3 is lit LED 4 is lit	Fully charged

Lamp indicator on the battery charger	Status
Constant red light	The battery charges
Flashing red light	The battery is too warm and will start to charge when the temperature is correct.
Constant green light	The battery is fully charged
Flashing red and green light	The battery is damaged and must be replaced

4.10 To examine the spark plug

NOTICE! Always use the recommended spark plug type! Use of the wrong spark plug can damage the piston/ cylinder.

- If the machine is low on power, difficult to start or runs poorly at idle speed: always check the spark plug first before taking other steps.
- If the spark plug is dirty, clean it and check that the electrode gap is ok. See Technical data. Replace if necessary.

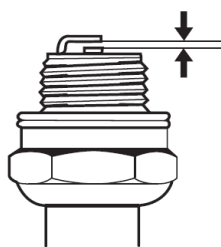

4.11 To adjust the drive belt

If the drive feels sluggish, it may be due to a slipping clutch and the clutch cable will then have to be adjusted.

Finely adjust the wire using the adjuster screw.

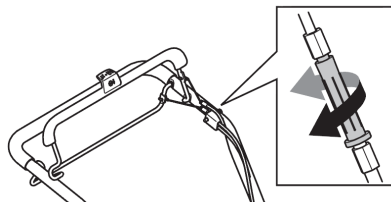

- To tension the wire and increase speed, screw the adjustment screw counterclockwise.

4.11.1 Variable Speed (LC 347V, LC 347VI, LC 353V, LC 353VI)

Adjust the speed of the above models by moving the control lever rearward for slow drive and forward for fast drive. Note that the lowest position can be engaged only when the machine is running. If the machine is running and the lowest position cannot be engaged, the control must be adjusted by unscrewing the adjustment screw.

Make sure the wires are not tensioned too tight. If the lawn mower starts to drive without the clutch lever is being operated, extend the wire.

- To extend the wire and reduce speed, screw the adjustment screw clockwise.

If the drive still feels slow, the belt will have to be replaced. Contact an authorised service workshop.

4.12 Air filter

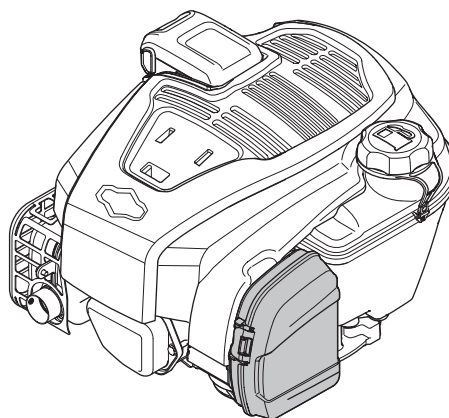

- Remove the air filter cover and take out the filter.
- An air filter that has been in use for a long time cannot be cleaned completely. The filter must therefore be replaced with a new one at regular intervals. A damaged air filter must always be replaced.
- When reassembling, make sure that the filter completely seals against the filter holder.

4.12.1 To clean the paper filter

Clean the filter by knocking the filter against a flat surface. Never use solvent with petroleum, for example, kerosene, or compressed air to clean the filter.

4.12.2 To clean the foam plastic filter (LC 247, LC 247S, LC 247SP)

Remove the foam plastic filter. Wash the filter well in tepid soapy water. After cleaning, rinse the filter well in clean water. Squeeze out and allow the filter to dry. NOTE! High pressure compressed air can damage the foam. After cleaning the filter should be oiled using engine oil. Wipe away excess oil by pressing a clean cloth against the filter.

4.12.3 To change the oil

IMPORTANT! Allow the machine to cool. Hot oil can cause severe burn injuries.

1. Empty the fuel tank.
2. Unscrew the oil filler cap.
3. Place a suitable vessel to collect the oil in.
4. Drain the oil by tipping the engine so that the oil runs out through the filler pipe. When the machine is tilted, make sure the air filter always is placed in the highest position. Ask where you can dispose of surplus engine oil at your local petrol station.

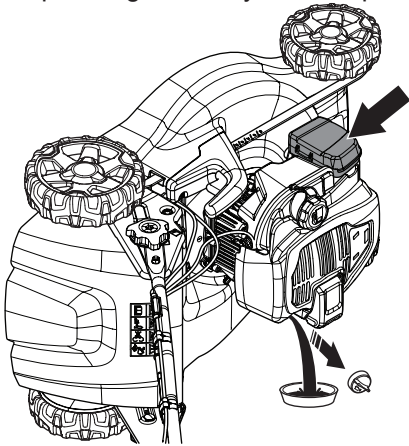

5. Fill with new engine oil of the right quality. See instructions in the section "Technical data".
6. Please see the engine Operator's Manual for more information.

4.12.4 To examine the fuel system

- Check that the fuel cap and its seal are not damaged.
- Check the fuel hose. Replace if necessary.

5 Specifications

5.1 Technical data 300 series

	LC 347V	LC 347VI	LC 353V	LC 353VI
Engine				
Engine manufacturer	Briggs & Stratton	Briggs & Stratton	Briggs & Stratton	Briggs & Stratton
Cylinder displacement, cm ³	163	163	163	163
Speed, rpm	2900	2900	2800	2800
Nominal engine output, kW ¹	2.4@2900	2.6@2900	2.4@2800	2.6@2800
Ignition system				
Spark plug	Champion XC92YC	Champion XC92YC	Champion XC92YC	Champion XC92YC
Electrode gap, mm	0.5	0.5	0.5	0.5
Fuel and lubrication system				
Fuel tank capacity, litre	1.0	1.0	1.0	1.0
Engine oil	SAE 30/SAE 10W-30	SAE 30/SAE 10W-30	SAE 30/SAE 10W-30	SAE 30/SAE 10W-30
Weight				
Weight with empty tanks, kg	30.0	32.0	32.8	34.2
Noise emissions ²				
Sound power level, measured dB (A)	95	95	96	96
Sound power level, guaranteed L _{WA} dB (A)	96	96	97	97
Sound levels ³				
Sound pressure level at the operators ear, dB (A)	84	84	85	85
Vibration levels ⁴				
Handle, m/s ²	4.2	4.2	4.0	4.0
Cutting equipment				
Cutting height, mm	20-75	20-75	20-75	20-75
Cutting width, cm	47	47	53	53
Blade	Collect	Collect	Collect	Collect
Article number	5882755-10	5882755-10	5797972-10	5797972-10
Bagger capacity, litre	55	55	60	60
Drive				
Speed, km/h	2.8-5.0	2.8-5.0	2.8-5.0	2.8-5.0
Start				
Electrical start		Yes	-	Yes
Battery		Li-ion, 10.8V/15.7Wh	-	Li-ion, 10.8V/15.7Wh

¹ The power rating of the engine indicated is the average net output (at specified rpm) of a typical production engine for the engine model measured to SAE standard J1349/ISO1585. Mass production engines may differ from this value. Actual power output for the engine installed on the final machine will depend on the operating speed, environmental conditions and other values.

² Noise emissions in the environment measured as sound power (L_{WA}) in conformity with EC directive 2000/14/EC.

³ Noise pressure level according to ISO 5395. Reported data for noise pressure level has a typical statistical dispersion (standard deviation) of 1.2 dB (A).

⁴ Vibration level according to ISO 5395. Reported data for vibration level has a typical statistical dispersion (standard deviation) of 0.2 m/s².

5.2 Technical data 200 series

	LC 247	LC 247S	LC 247SP	LC 253S
Engine				
Engine manufacturer	Briggs & Stratton	Briggs & Stratton	Briggs & Stratton	Briggs & Stratton
Cylinder displacement, cm ³	125	125	140	163
Speed, rpm	2900	2900	2900	2800
Nominal engine output, kW ¹	1.8@2900	1.8@2900	2.1@2900	2.4@2800
Ignition system				
Spark plug	Champion QC12YC	Champion QC12YC	Champion QC12YC	Champion XC92YC
Electrode gap, mm	0.5	0.5	0.5	0.5
Fuel and lubrication system				
Fuel tank capacity, litre	0.8	0.8	0.8	1.0
Engine oil ²	SAE 30/SAE 10W-30	SAE 30/SAE 10W-30	SAE 30/SAE 10W-30	SAE 30/SAE 10W-30
Weight				
Weight with empty tanks, kg	27.5	29.5	30.0	32.4
Noise emissions ³				
Sound power level, measured dB (A)	96	96	94	96
Sound power level, guaranteed L _{WA} dB (A)	96	96	96	97
Sound levels ⁴				
Sound pressure level at the operators ear, dB (A)	85	85	84	85
Vibration levels ⁵				
Handle, m/s ²	3.4	3.4	3.4	4.0
Cutting equipment				
Cutting height, mm	20-75	20-75	20-75	20-75
Cutting width, cm	47	47	47	53
Blade	Collect	Collect	Collect	Colect
Article number	5882755-10	5882755-10	5882755-10	5797972-10
Bagger capacity, litre	55	55	55	60
Drive				
		4	4	4

¹ The power rating of the engine indicated is the average net output (at specified rpm) of a typical production engine for the engine model measured to SAE standard J1349/ISO1585. Mass production engines may differ from this value. Actual power output for the engine installed on the final machine will depend on the operating speed, environmental conditions and other values.

² Use engine oil of quality SF, SG, SH, SJ or higher. See the viscosity chart in the engine manual and select the best viscosity based on the expected outside temperature.

³ Noise emissions in the environment measured as sound power (L_{WA}) in conformity with EC directive 2000/14/EC.

⁴ Noise pressure level according to ISO 5395. Reported data for noise pressure level has a typical statistical dispersion (standard deviation) of 1.2 dB (A).

⁵ Vibration level according to ISO 5395. Reported data for vibration level has a typical statistical dispersion (standard deviation) of 0.2 m/s².



www.husqvarna.com

115 93 85-26

2017-08-22