

# VITALS

КЕРІВНИЦТВО З ЕКСПЛУАТАЦІЇ

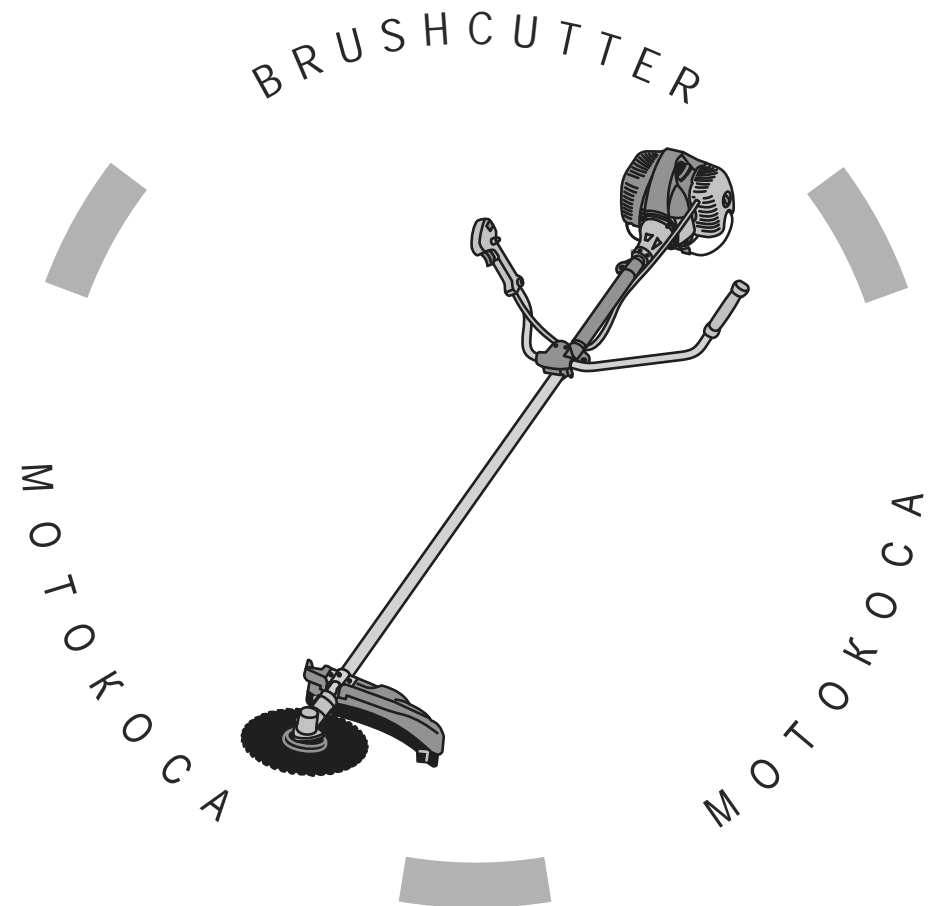

[WWW.VITALS.COM.UA](http://WWW.VITALS.COM.UA)



МОДЕЛ

БК 5223а

ÓΕΔΑ-Ϊ ΝÜΕΑ

- 1.
- 2.
- 3.
- 4.
- 4.1.
- 4.2.
- 5.
- 5.1.
- 5.2.
- 6.
- 7.
- 8.
- 9.



- 6
- 10
- 11
- 12
- 12
- 12
- 17
- 17
- 27
- 31
- 39
- 41
- 43

!

«Vitals».

«Vitals»

«Vitals»

?

?

«  
, 70, . 056-374-89-39.

Vitals Professional BK 5223a

EN 28662-1-2001, ISO 11806:2006.

«  
. 056-374-89-39.

056-374-89-38,

www.vitals.com.ua.

«Vitals».



[Redacted text block]



[Redacted text block]



[Redacted text block]

Vitals Professional BK 5223a

40-

Vitals Professional BK 5223a ( - )

20

28

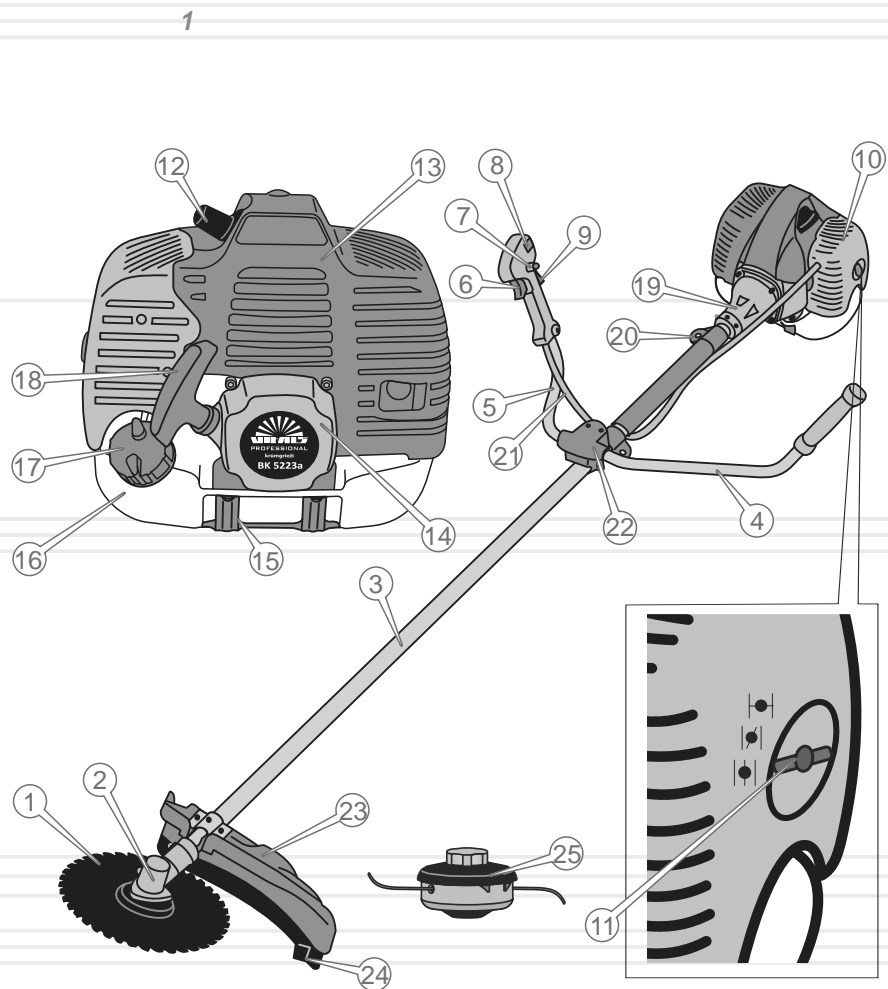

- 1.
- 2.
- 3.
- 4.
- 5.
- 6.
- 7.
- 8.
- 9.
- 10.
- 11.
- 12.
- 13.
- 14.
- 15.
- 16.
- 17.
- 18.
- 19.
- 20.
- 21.
- 22.
- 23.
- 24.
- 25.

2

3

УКРАЇНСЬКА

1. ( , , )
- 2.
- 3.
- 4.
- 5.
- 6.
- 7.
- 8.
9. 40-
- 10.
- 11.
- 12.
- 13.
- 14.
- 15.



!

- , -

,

.

1

|         |                        |
|---------|------------------------|
|         | 5223                   |
|         |                        |
|         | 25:1                   |
| , , 3   | 52,0                   |
| , / . . | 2,3/3,1                |
| / , /   | 2,9/5000               |
| , /     | 7500                   |
| , ,     | 1,1                    |
| ,       | 110                    |
| ,       | 420                    |
| ,       | 255                    |
| ,       | 2,4                    |
| ,       | 28                     |
|         | +                      |
|         | +                      |
|         | +                      |
|         | +                      |
|         | +                      |
|         | +                      |
|         | +                      |
|         | +                      |
| ( / ),  | 300 300 300/1530 30 30 |
| / ,     | 9,1/9,9                |

УКРАЇНСЬКА

10

11

4.1.

4.

5.

6.



[Redacted text block]

7.

8.

9.

4.2.

1.

2.

3.

16

( 15 )

10.

18.

11.

19.

20.

12.

( 15 )

21.

13.

22.

14.

23.

15.

24.

16.

25.

26.

17.

27.





[Redacted text block]



[Redacted text block]

2

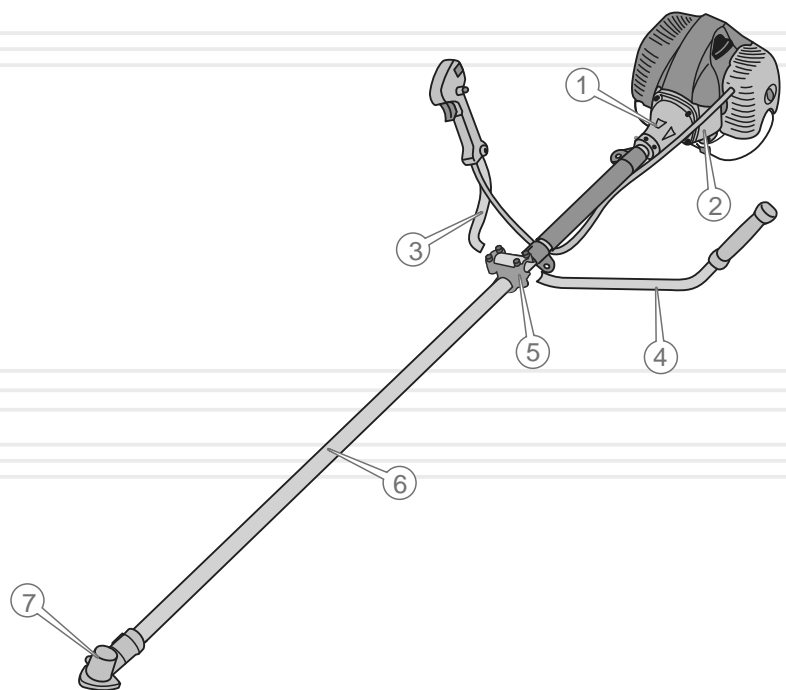

5.1.

- 1. [Redacted]
- 2. [Redacted]
- 3. [Redacted]
- 4. [Redacted] (7) (6).
- 5. [Redacted] 4 5 (1) (6).
- 6. [Redacted] 5 (1) (2)
- 7. [Redacted] 5

1. (5) (3, 4)
2. (3) (4) 2.
- 3.
- 4.

3

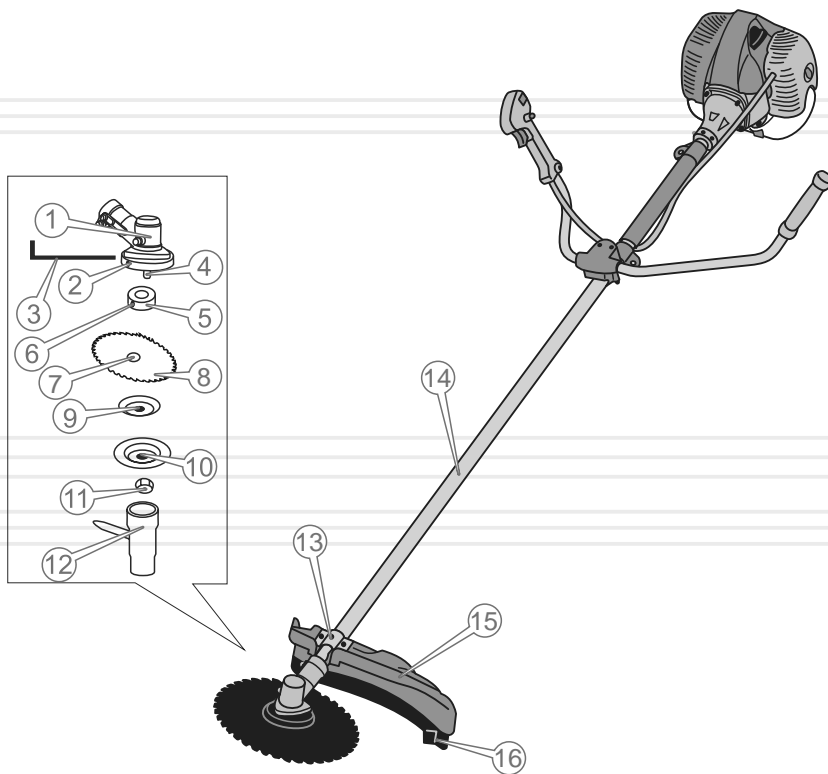

18

1. (16) (15)
2. (3).
3. (14). (13),
4. (15) (13) 8



4.

1. (4) (5) (1)
- (2) (6)
2. (3), (2) (1)
3. (4) (4) (8) (5)
- (7).

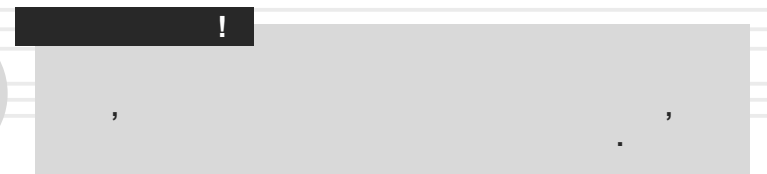

4. (10), (4) 19 (9), (12), (11).

19



[Redacted text]

- 5. (1) (3) (2)
- 6. .



[Redacted text]

4



[Redacted text]

- 1. (4) (5) (1) (6)
- (2) (4).
- 2. (2) (1)
- 3. (3), (4), (4) (7).
- 4. (4) (8) (9).



[Redacted text]

- 5. (1) (3) (2)
- 6. .



[Redacted text]

- 1.
- 2.
3. ( ) ( (20) 1).
4. 4



10-20 ( 5).

5



5.



!



! 25:1.

- 1.
  2. (!)
  3. (17) (
  4. 1). 1,1 (
  - 5.
  - 6.
- - 
  - 
  -

10



[Redacted text block]

- 1. ,
- 2. ( 1). (8) «|»
- 3. 6.

6

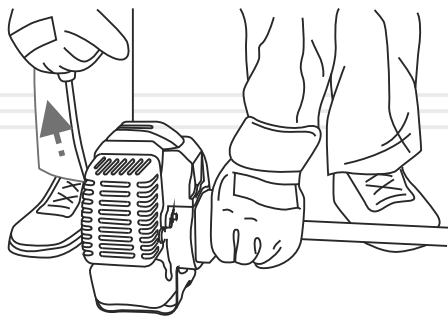

- 4. " ». 3-5  
« »,  
« »,
- 5. (11) ( 1) |.

- 6. (18) ( 1),  
( ) .



[Redacted text block]



[Redacted text block] 5-10 ( 8 »), «

- 7. , ,
- 8. ,
- 9. (11) ( 1)



[Redacted text block]



[Redacted text block] (+5°) |.

+5° .

1. , 5

2. (8) «l» (

3. 1).

4. 6. 3-5

« ».

».

« ».

5. (11) ( 1) .

6. (6) ( 1).

7. (18) ( 1),

).

8.

9.

10.

11. (11) ( ) .

1) .

!

(6) ( 1)

1-3

(8) ( 1) «0».

!

!

!

!

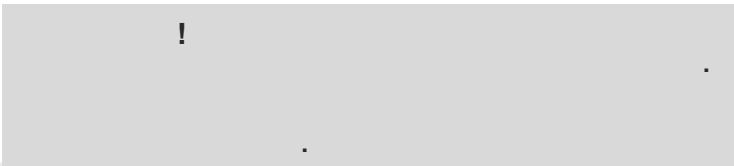

- 1.
- 2.
- 3.

(15-17 ).  
(24),  
(23) ( 1).

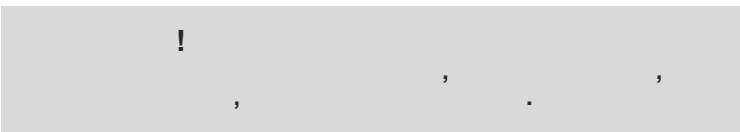

7

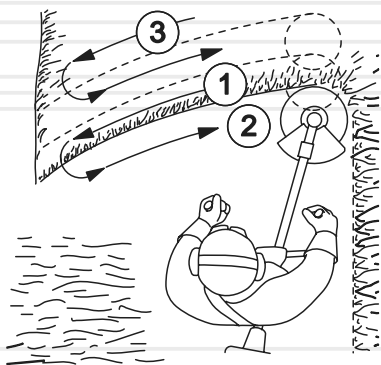

8

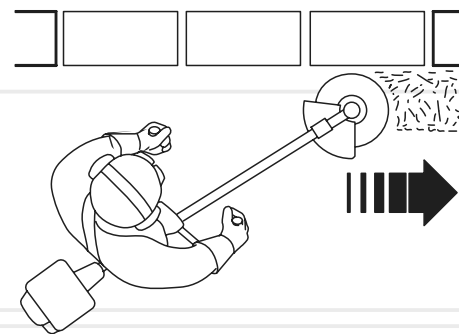

8,

9

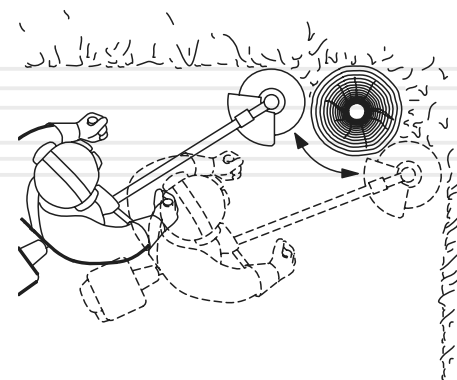

( 9).

20

10

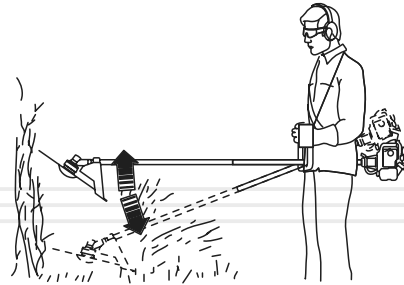

10.



[Redacted text block]



[Redacted text block]



[Redacted text block]



[Redacted text block]



|  |  |   | 25 | 50 | 100 |
|--|--|---|----|----|-----|
|  |  | • |    |    |     |
|  |  | • |    |    |     |
|  |  | • |    |    |     |
|  |  | • |    |    |     |
|  |  | • |    |    |     |
|  |  |   | •* |    |     |
|  |  |   |    |    |     |
|  |  | • | •* |    |     |
|  |  |   |    |    |     |
|  |  | • |    |    |     |
|  |  |   | •* |    |     |
|  |  |   |    |    | •*  |
|  |  | • |    |    |     |
|  |  | • |    |    |     |
|  |  |   |    |    |     |
|  |  |   |    |    |     |
|  |  |   |    | •* |     |
|  |  |   |    |    | •*  |
|  |  | • |    |    |     |
|  |  |   |    |    |     |
|  |  |   |    | •  |     |
|  |  |   |    |    |     |

\* -



!

1. ( . 11)
2. ( )
3. ( )
4. (2) (1) ( ) (3)
5. 2,4
6. (4) (3) ( )



!

11

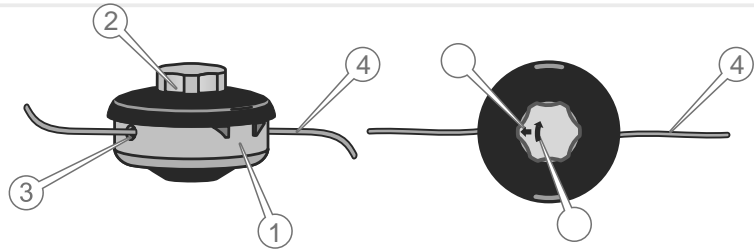

7.

(2)

( ),

15-17



!

0,6 - 0,7

12

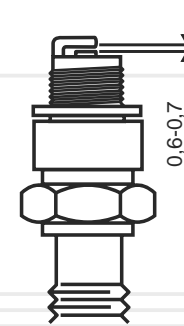

!



!

( 5 ).

34

35

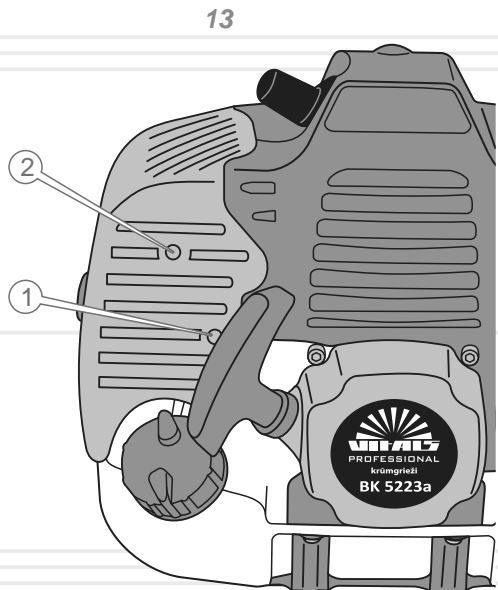

( . 13)

- 1.
- 2.
- 3.
- 4.
- 5.
- 6.

2,5±0,5

13±1

2-5

0,5 ),



!

' 3 , ,



!

25

).



!

( , 50 ) ,



! [Redacted]



! [Redacted]  
( , )



! [Redacted]



! [Redacted]

90%.

-15° +55° ,

90%.

-15° +55° ,







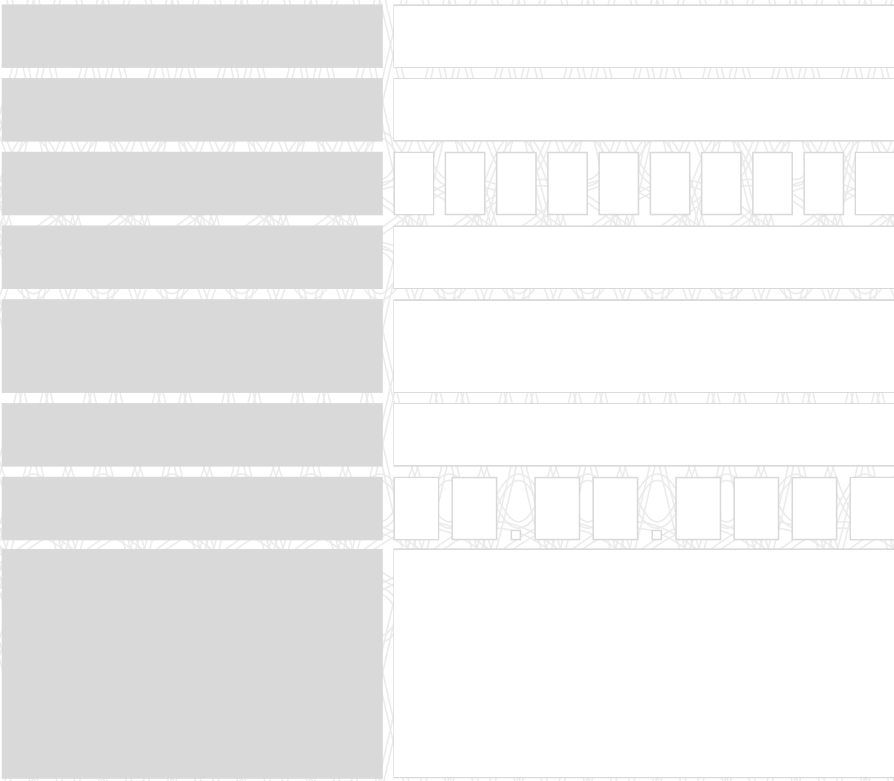
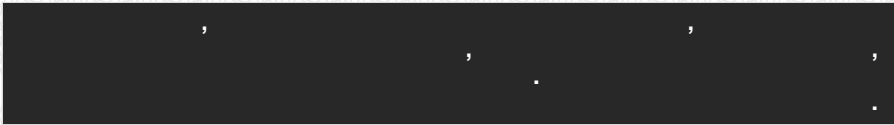

( ):

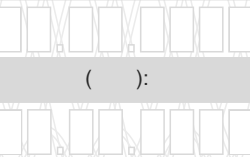

( )



( ):

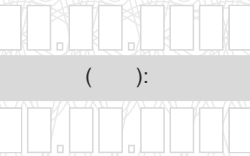

( )



( ):

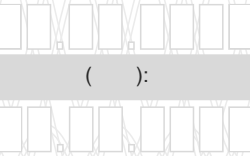

( )

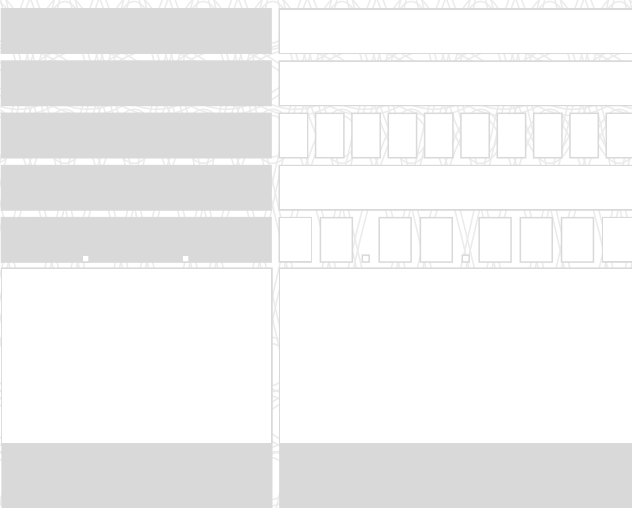
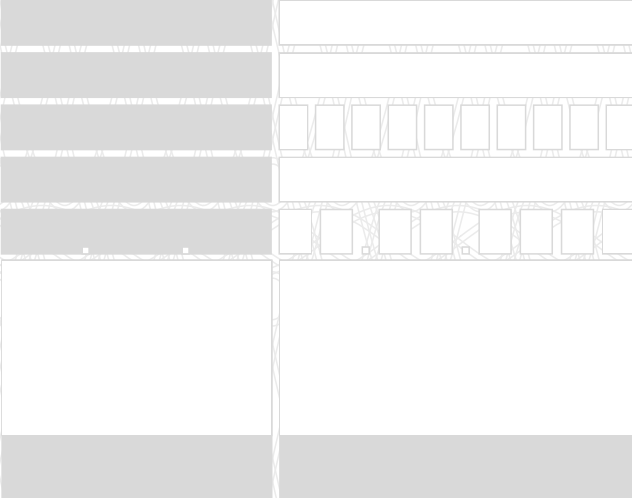
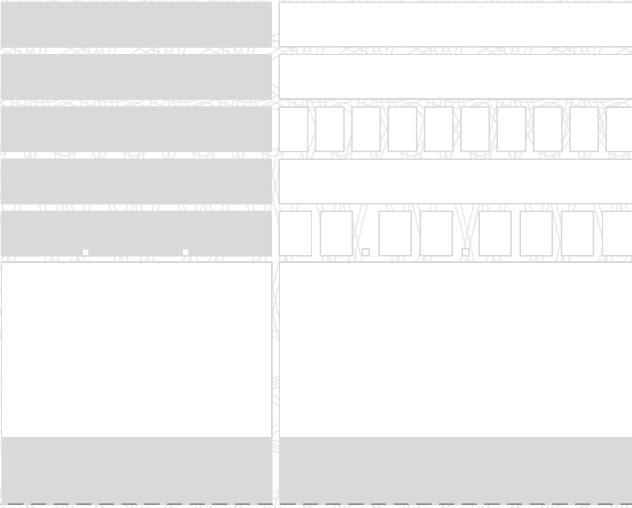



A horizontal form with a black border. It contains three white input fields of varying widths. The top right corner of the form has a small white triangle. Below the input fields, there are three small black dots. The form is set against a background of a complex, repeating geometric pattern of overlapping circles and lines.

A horizontal form with a black border, identical in structure to the one above. It contains three white input fields. The top right corner has a small white triangle. Below the input fields, there are three small black dots. The form is set against the same complex geometric pattern background.

A horizontal form with a black border, identical in structure to the ones above. It contains three white input fields. The top right corner has a small white triangle. Below the input fields, there are three small black dots. The form is set against the same complex geometric pattern background.



| ? |  |  |  |
|---|--|--|--|
|   |  |  |  |
|   |  |  |  |
|   |  |  |  |
|   |  |  |  |
|   |  |  |  |

